

[This document consists of 3 pages.]

Terms and Conditions:*

RETURN POLICY:

Requests for returns must be made within 15 days of date of delivery. Please inspect the order upon arrival and notify Mediacage LLC immediately about missing or damaged parts. Damaged parts must be returned to receive a replacement. If returning for a refund, ordered items must be in unused condition, without evidence of trial fitment, or any other modification. Return requests must be in writing. Email requests to support@mediacage.com

WARRANTY AND LIMITATION OF LIABILITY:

MEDIACAGE LLC EXPRESSLY DISCLAIMS ALL EXPRESS OR IMPLIED WARRANTIES, INCLUDING THE WARRANTY OF MERCHANTABILITY AND FITNESS FOR A PARTICULAR PURPOSE. Mediacage LLC's and its member/s' liability for any claim arising from or relating to the Goods is limited to the purchaser price of the Goods, provided Purchaser returned the Goods or the repair or replacement of the Goods or parts thereof at the election of Mediacage LLC. In no event shall Mediacage LLC or its member/s be liable for any direct, indirect, punitive, incidental, special, consequential damages, or any damages whatsoever arising out of or connected with the use or misuse of this Product. Mediacage LLC or its member/s shall not have any obligation with respect to the Product or any part thereof, whether based on contract, tort, and strict liability or otherwise. BUYER ASSUMES ALL RISK AND LIABILITY FROM USE OF PRODUCT.

General Notice:

The taillight modification bracket and taillight are provided for use purely as an aesthetic appearance alternative to Original Equipment taillight as factory-installed with the vehicle. Use of this bracket is not intended to improve factory installed equipment performance, and in certain circumstances, may possibly degrade performance.

*Terms and Conditions subject to change without notice.

Reference Instructions for Taillight Bracket modification, for Honda Shadow Spirit VT750DC

Please read through the entire reference instructions and Terms and Conditions before proceeding with the installation.

Parts included:

- main bracket, polished, chromed
- wide cateye taillight, w/ 36" long wires (if ordered)
- fasteners: (2) ¼" x ½" bolts, nuts, (4) washers for main bracket
- (2) small washers for mounting taillight to main bracket

Rear fender assembly:

- remove seat – two bolts on side
- remove seat holding metal bracket (7,22)
- disconnect rear wiring harness from wiring cluster above battery; these include rear turn signal and rear brakelight wires
- remove 2 bolts on each side of rear fender strut (9,16); this will loosen the rear fender entirely
- lift off the rear fender assembly carefully, making sure not to scratch paint !
- remove seat nut (17), and carefully separate fender (12) from metal frame (13)

Brake light removal:

[make careful note of wiring in fender frame]

- remove wiring harness from clips; clip edged tend to be sharp; use caution.
- remove stock metal taillight bracket (10)

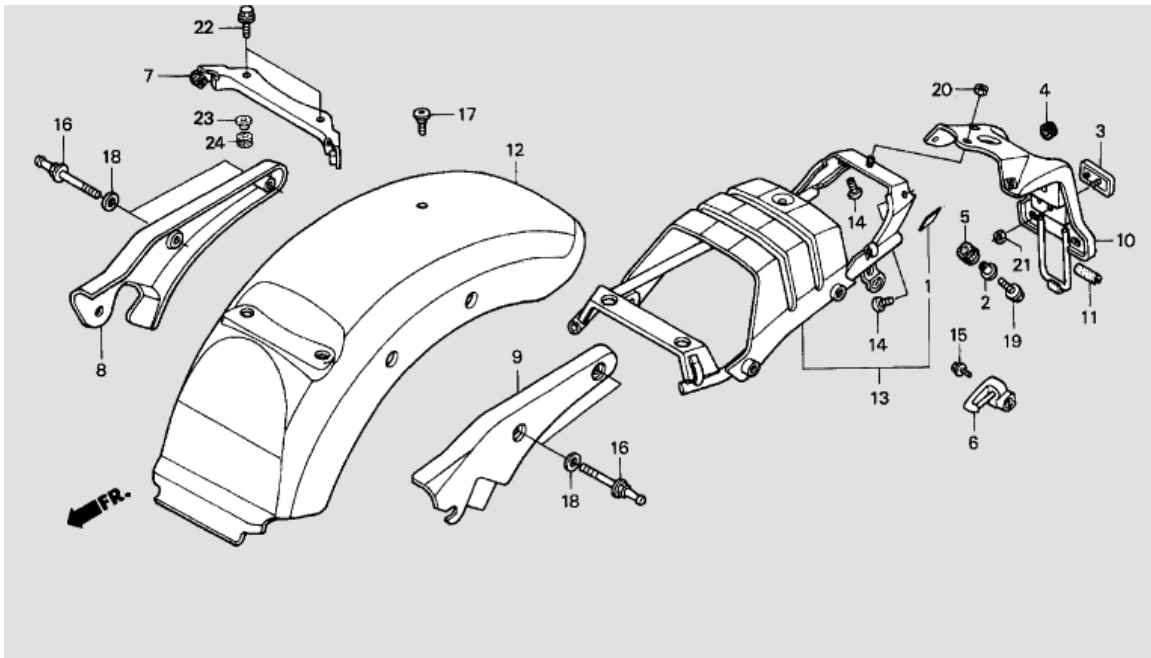

New Bracket installation:

- install new license plate (and frame, if any) **BEFORE** installing taillight on bracket
- pass wires on the wide cateye taillight through main bracket, and fasten taillight on the bracket using two bolts on the light; make sure to install the light so that clear window faces downward, toward lic. plate
- install new bracket over metal fender frame as shown; loosely fasten one side tab, press bracket over other side, and fasten the other tab, and tighten bolts evenly.
- re-install wires through clips in fender frame; make sure wiring is properly routed, to avoid interference with rear wheel, fender bolts, etc.
- re-install fender assembly; used specified Torque values (47 ft. lb; per service manual)
- reconnect rear turn signal wires (brakelight connection – see below)

Brakelight Wiring Key: (for taillights with 36" wires ONLY)

- Black wire on taillight to green wire [-ve ground]
- Yellow wire on taillight to Brown wire [running lamp circuit]
- Red wire on taillight to Green/Yellow striped wire [brake circuit]
- Turn switch on; test brake light function before riding, while bike is stationary; if brake light remains ON (bright) and dims when brakes are applied, swap red and yellow wire connections; check again for correct brakelight function.

www.motorcyclemods.com
support@mediacage.com

FENDER

ASSEMBLY REMOVAL/INSTALLATION

Remove the seat (page 2-2).

Disconnect the brake/taillight, rear turn signal wire connectors located in the connector boot.

Remove the four bolts, washers and rear fender assembly from the frame to avoid scratching the rear fender.

TORQUE:

Rear fender bolt: 64 Nm (6.5 kgf-m, 47 lbf-ft)

DISASSEMBLY/ASSEMBLY

Remove the two bolts and seat bracket.

Remove the setting bolt.

Remove the screw and collar, then remove the rear fender from the sub-frame.

Assembly is in the reverse order of disassembly.

Remove these 3 bolts
to remove taillight brkt.;

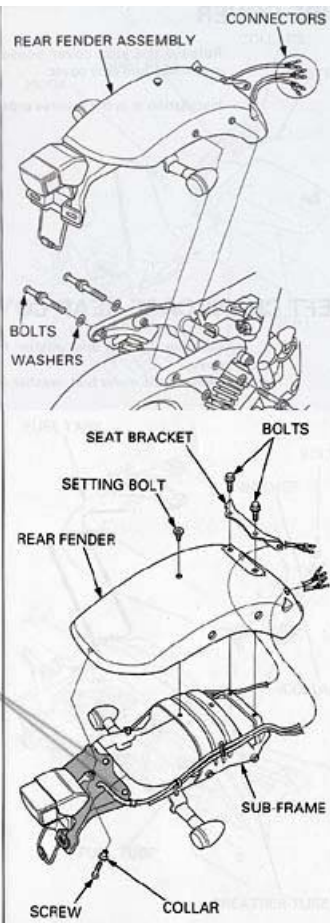

Troubleshooting, if blowing fuses after installation:

- Perform a taillight only connection check, prior to re-installing the complete assembly back on the fender rails. If fuses short, check the bulb housing, to make sure the running and ground leads aren't touching.
- make sure wires aren't snagged or pinched, and are clear of the fender mounting bolts.

Always perform a pre-ride check as outlined in your owners' manual.