

[POWER] [COMMANDER III]

CERTIFIED **USB**

2001-2003 Aprilia Futura Installation Instructions

Parts List

- 1 Power Commander
- 1 USB Cable
- 1 CD-ROM
- 1 Installation Guide
- 1 Power Adapter
- 2 Power Commander Decals
- 2 Dynojet Decals
- 1 Velcro® Strip
- 1 Alcohol Swab
- 1 Wire tap

The ignition MUST be turned OFF before installation!

You can also download the Power Commander software and latest maps from our web site at:

www.powercommander.com

Button Adjustment Display



Faceplate Buttons

Expansion Port

USB Port



PLEASE READ ALL DIRECTIONS BEFORE STARTING INSTALLATION

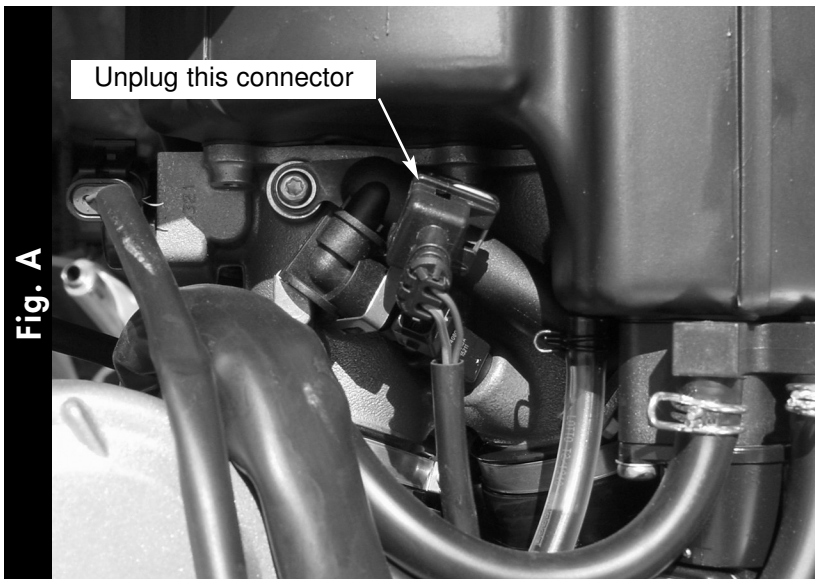

- 1 Remove the seat.
- 2 Lift up the front of the fuel tank.
- 3 Disconnect the wiring harness from the injector on the right hand side of the bike by pushing up (squeeze) on the spring clips from the injector connector (Fig. A).

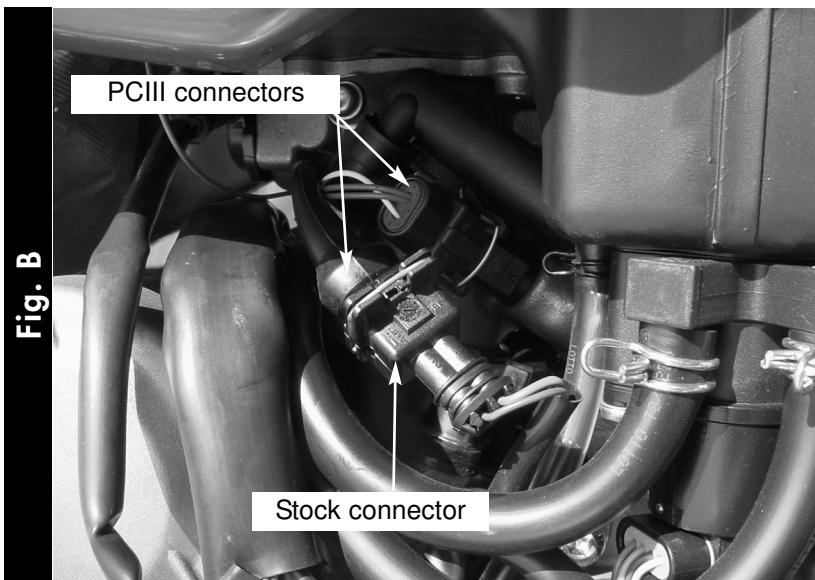

- 4 Plug one of the leads from the PCIII in line of the stock connector and injector (Fig. B).
- 5 Repeat steps 3-4 for the left hand side.

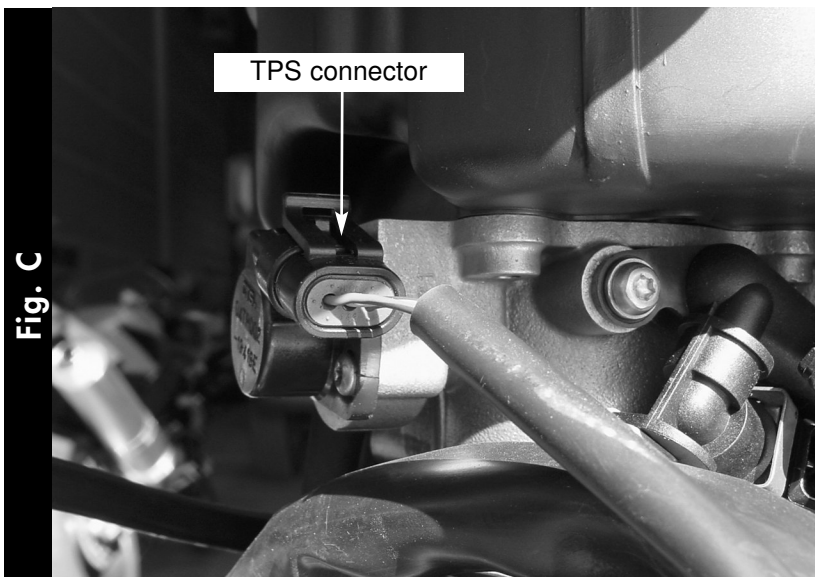

- 6 Unplug the wiring harness from the throttle position sensor (Fig. C). The sensor is located on the back side of the throttle body.

Fig. D

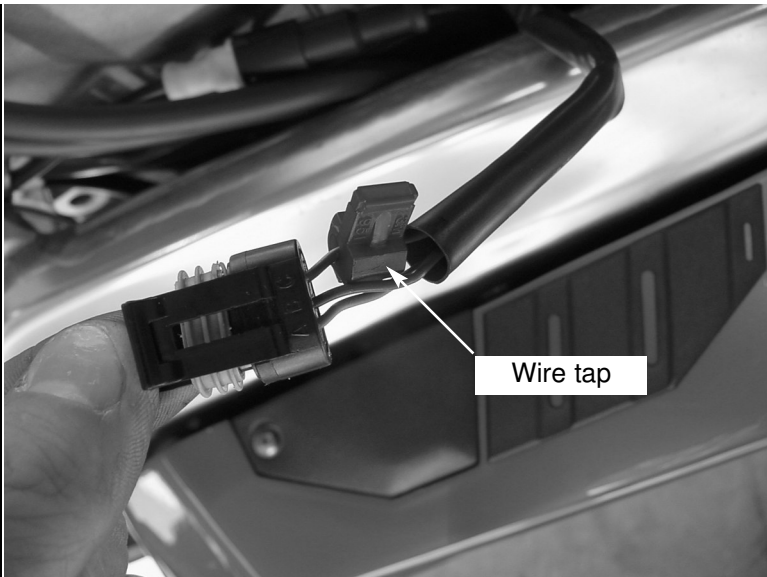

- 7 Attach the supplied wire tap to the brown wire with a white tracer (Fig.D).

Note: It is recommended to use dielectric grease at this connection.

Fig. E



- 8 Attach the grey wire from the PCIII to the wire tap.

Note: It is recommended to use dielectric grease at this connection.

Fig F

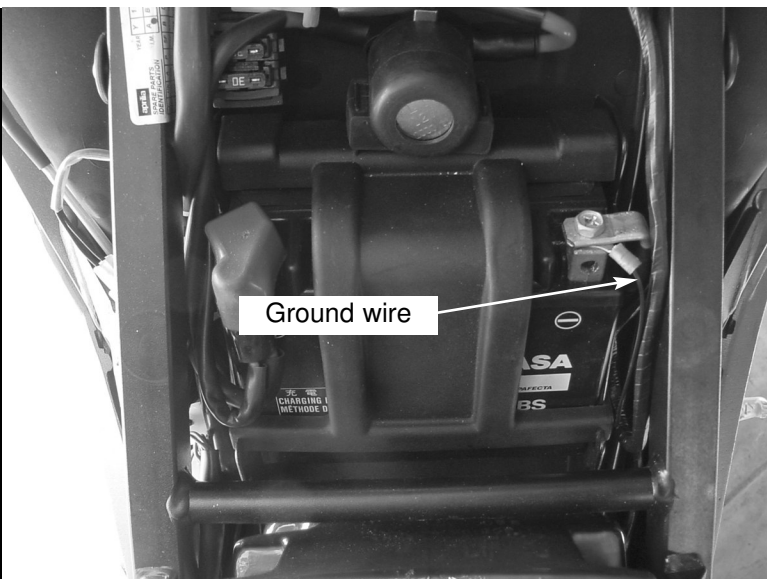

- 9 Attach the ground wire from the PCIII to the negative side of the battery (Fig.F).

Fig. G



- 10 Install the PCIII under the tool kit. If you do not use the tool kit use the supplied velcro to attach the PCIII (Fig. G).