



INSTALLATION

HANDLEBAR CONTROL DRESS-UP KIT, '14-UP TOURING 1739

THANK YOU FOR CHOOSING KÜRYAKYN!

PROTECT YOURSELF AND OTHERS FROM POSSIBLE INJURY AND PROPERTY DAMAGE OR LOSS. PAY CLOSE ATTENTION TO ALL INSTRUCTIONS, WARNINGS, CAUTIONS, AND NOTICES REGARDING THE INSTALLATION, USE, AND CARE OF THIS PRODUCT.

	WARNING	THIS INDICATION ALERTS YOU TO THE FACT THAT IGNORING THE CONTENTS DESCRIBED HEREIN CAN RESULT IN POTENTIAL DEATH OR SERIOUS INJURY.
	CAUTION	This indication alerts you to the fact that ignoring the contents described herein can result in minor or moderate potential injury.
	NOTICE	This indication alerts you to the fact that ignoring the contents described herein may negatively affect product performance and functionality or damage the product itself or the product to which it is being attached.

MAKE SURE THE FOLLOWING PARTS HAVE BEEN INCLUDED IN THE KIT:

- 1 Left-Side (Clutch) Cover
- 1 "LEFT" Bracket
- 1 Left-Side (Clutch) Filler Panel
- 1 Right-Side (Brake) Cover
- 1 "RIGHT" Bracket
- 1 Right-Side (Brake) Filler Panel
- 2 Half Clamps
- 1 Hardware Kit containing:
 - 2 M4 X 0.7 X 25MM Button Socket Head Cap Screws
 - 2 M4 X 0.7 X 20MM Button Socket Head Cap Screws
 - 4 10-24 X 5/16" Button Socket Head Cap Screws
 - 4 1/4"-20 X 1" Socket Head Cap Screws
 - 2 Small Clips
 - 2 Large Clips
 - 2 Brake Line Bottom Cover
 - 2 Brake Line Top Cover
- 1 Installation Instructions

YOU WILL ALSO NEED:

Phillips head screw driver, set of hex wrenches, paper towels, tank service cover, warm, soapy water and a clean rag, ammonia-based cleaner

	NOTICE	These installation instructions contain important information. Ensure that the end user receives this copy and is aware of its importance for future reference.
--	---------------	--

STEP 1 Read and understand all steps in the instructions before starting the installation. Park the motorcycle on a hard, level surface and turn **IGN OFF**. Remove the main fuse.

CUSTOMER SERVICE
877.370.3604 (toll free)

INSTALLATION QUESTIONS
techsupport@kuryakyn.com
or call 715.247.2983

LIMITED WARRANTY

Kuryakyn warrants that any Kuryakyn products sold hereunder, shall be free of defects in materials and workmanship for a period of one (1) year from the date of purchase by the consumer excepting the following provisions:

- Kuryakyn shall have no obligation in the event the customer is unable to provide a receipt showing the date the customer purchased the product(s).
 - The product must be properly installed, maintained and operated under normal conditions.
 - Kuryakyn makes no warranty, expressed or implied, with respect to any gold plated products.
 - Kuryakyn shall not be liable for any consequential and incidental damages, including labor and paint, resulting from failure of a Kuryakyn product, failure to deliver, delay in delivery, delivery in nonconforming condition, or for any breach of contract or duty between Kuryakyn and a customer.
- Kuryakyn products are often intended for use in specific applications. Kuryakyn makes no warranty if a Kuryakyn product is used in applications other than intended.
- Kuryakyn electrical products are warranted for one (1) year from the date of purchase by the consumer. L.E.D.'S contained in components of Kuryakyn products will be warranted for defects in materials and workmanship for 3 years from the date of purchase where as all other components shall be warranted for one(1) year. This includes, but is not limited to; control modules, wiring, chrome & other components.
 - Kuryakyn makes no warranty of any kind in regard to other manufacturer's products distributed by Kuryakyn. Kuryakyn will pass on all warranties made by the manufacturer and where possible, will expedite the claim on behalf of the customer, but ultimately, responsibility for disposition of the warranty claim lies with the manufacturer.

ABOUT OUR CATALOG

For purchasing Kuryakyn® products, you can receive a complete catalog free of charge. Send the Proof-of-Purchase below with your address to: Kuryakyn
454 County Road V V
Somerset, WI 54025-9031
Please indicate either Accessories Catalog for Harley-Davidson® or GL & Metric Cruisers.

Be sure to ask your local dealer about other Kuryakyn® products, the motorcycle parts and accessories designed for riders by riders.

©2005 Kuryakyn USA® All Rights reserved.





WARNING

THE END USER'S SAFETY DEPENDS UPON PROPER INSTALLATION OF THIS PRODUCT. IF A STEP IN THESE INSTRUCTIONS IS NOT WITHIN YOUR CAPABILITIES OR YOU DO NOT HAVE THE CORRECT TOOLS, HAVE YOUR DEALER PERFORM THE PROCEDURE. IMPROPER INSTALLATION OF THIS PRODUCT COULD RESULT IN DEATH OR SERIOUS INJURY.

ACCIDENTAL VEHICLE START-UP COULD CAUSE DEATH OR SERIOUS INJURY, REMOVE THE MAIN FUSE BEFORE PROCEEDING.

Kuryakyn®

NOTICE

Avoid damage to the motorcycle. Protect painted surfaces with a soft cloth or blanket.

MASTER CYLINDER COVER INSTALLATION:

STEP 2 Remove the existing **HANDLEBAR MOUNTED** mirrors (if equipped); set them aside, they will be reinstalled later.

STEP 3 Refer to **PIC 1**. Locate the included **RIGHT** Bracket, one of the M4 X 0.7 X 25MM Button Socket Head Cap Screws, and one of the M4 X 0.7 X 20MM Button Socket Head Cap Screws; set them within arms reach of the work area.

STEP 4 Position the handlebars so that the Brake-side (right) master cylinder is as level as possible (to prevent brake fluid leaks once the screws have been loosened);

Loosen ONE of the master cylinder screws;

Refer to **PIC 2**. Push upward on the bottom of the screw head as it is being loosened (as shown in **PIC 1**) until it engages in the threads in the master cylinder cap;

Remove the screw; set it aside, it will not be reused.

STEP 5 Refer to **PIC 3**. Align the **RIGHT** Bracket so that the arrow points towards the bike;

Insert the 25MM Screw through the Bracket, then thread it into the master cylinder cap;

Refer to **PIC 3**. Carefully thread the Screw into the master cylinder; leave it loose enough to keep the cap sealed while allowing the Bracket to "swing" around to the other screw hole.

STEP 6 Remove the other screw from the master cylinder cap using the same technique as before; set it aside, it will not be reused.

STEP 7 Refer to **PIC 4**. Rotate the Bracket until the holes align;

Thread one of the 20MM Screws into the cap, then master cylinder.

STEP 8 Tighten both Screws and check for fluid leaks. Clean any leaking fluid immediately with a rag; DOT 4 brake fluid is VERY harmful to painted surfaces and must be removed immediately.

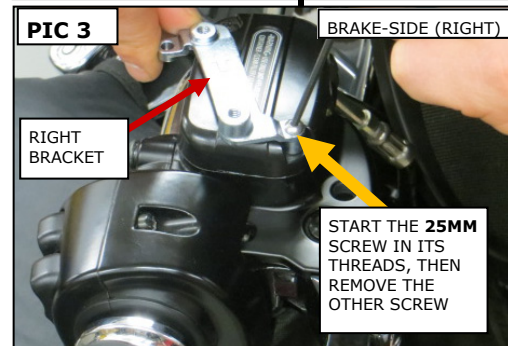
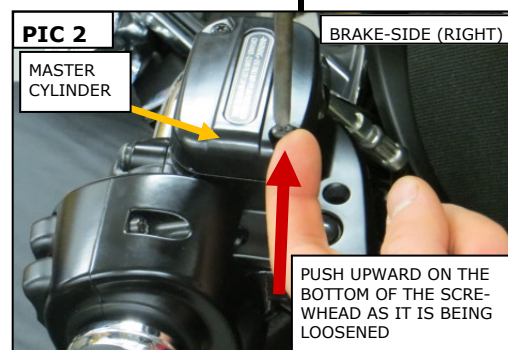
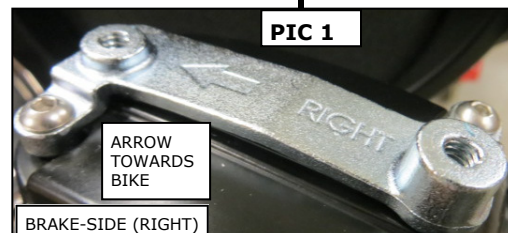

-cont.-

DOT 4 brake fluid will damage painted surfaces.

PAGE

2

STEP 9 Refer to **PIC 5**. Locate the Right-Side (Brake) Cover in the kit; position the Cover over the master cylinder and align the screw holes.

STEP 10 Secure the Cover to the Bracket with two of the included 10-24 X 5/16" Button Socket Head Cap Screws.

STEP 11 (Models without Handlebar Mounted Mirrors) Refer to **PIC 6 and 7**. Locate the Right-Side (Brake) Filler Panel in the kit; ensure that the front side of the new Cover is free of oil, grease, and debris; rub the adhesive backing to activate the adhesive; remove and discard the adhesive backing; press the Filler Panel into place for 60 seconds; full adhesive bond will occur after 24 hours.



HALF CLAMP INSTALLATION:

STEP 11 Locate one of the Half Clamps in the kit (they are NOT side-specific); set it and two of the included 1/4"-20 X 1" Socket Head Cap Screws within arms reach of the work area.

STEP 12 Secure the master cylinder/lever assembly while you remove the two existing clamp screws as shown in **PIC 8**; set the clamp and screws aside, they will not be reused.

STEP 13 Position the new Half Clamp over the handlebar; align the screw holes and secure with the 1/4" Screws.

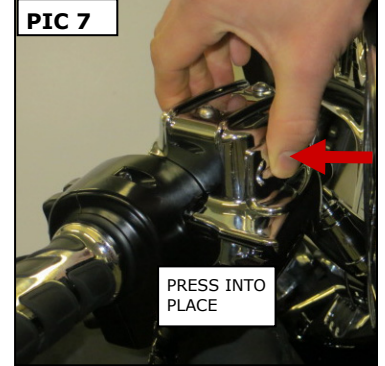
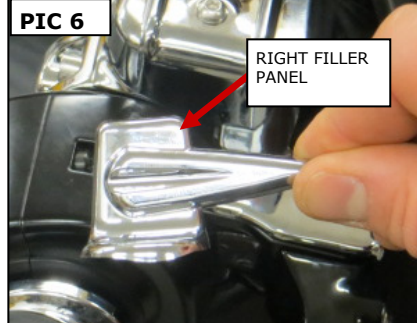

Tighten the top screw first, then the bottom screw; the gap between the clamp and master cylinder/lever assembly should be at the bottom.

BRAKE LINE COVER INSTALLATION:

STEP 14 Locate one of the Brake Line Cover sets in the kit (they are NOT side-specific); unwrap the protective plastic; using a small screw driver, GENTLY pry the halves apart.

STEP 15 Refer to **PIC 9**. Position the clamp halves over the brake line; the larger end fits over the metal portion of the line.

STEP 16 Refer to **PIC 10**. Secure the halves together with the large and small clips; press them onto the Cover until they snap into place in the grooves.

STEP 17 Repeat **STEPS 3 through 16** for the other side.

STEP 18 Reinstall the main fuse.

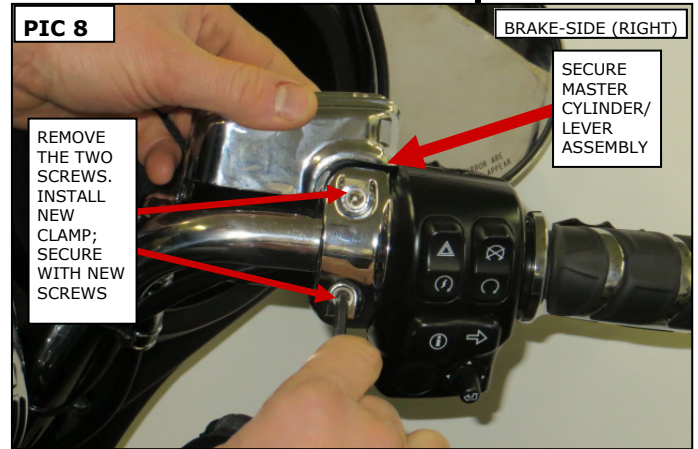

BEFORE RIDING, ENSURE THAT THE INSTALLATION OF THIS PRODUCT DOES NOT INTERFERE WITH THE PROPER OPERATION OF THE MOTORCYCLE.

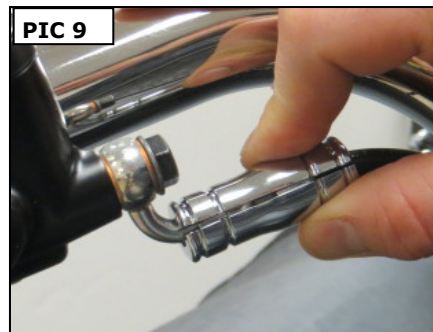

NOTICE

Ride On!

It is the end user's responsibility to ensure that all of the fasteners (including pre-assembled) are tightened before operation of the motorcycle. Kuryakyn will not provide warranty coverage on products or components lost or damaged due to improper installation or lack of maintenance. Periodic inspection and maintenance are required on all fasteners.