



## CIRO LIGHTED FLAG KIT

Parts Included:	1	LIGHTED FLAG ASSEMBLY
	1	WIRING KIT
	1	SWITCH INSTALL KIT
	1	5/32 HEX KEY
	1	3/16 HEX KEY

### INSTALLATION INSTRUCTIONS:

This installation requires that you have a basic understanding of the electrical system of your motorcycle. It is a simple installation, but if you have ever said; "wiring is not my thing" then have this product installed by a qualified mechanic.

1. Park on a level surface and shut off the motorcycle. Ensure the engine has time to cool before installation.
2. Determine where you want to mount the Lighted Flag and install the appropriate mount. Follow the instructions provided with the mounting kit then wire the flag mast as described below.
3. Carefully route the wire to the chosen power source. This step might require you to remove the seat and some body panels. Double check that the wires do not bind nor get pinched then secure them with the provided zip ties.

### Installation options:

#### Note:

On late model H-D motorcycles the key ON, ACCY power is most often a dark blue wire. (FIG.1) (FIG.2) Ground is black.

-To control the Lighted Flag with key on power.

Use a test light to locate key on power and tap into the wires using the provided posi tap connectors.

-To control the Lighted Flag with the provided switch.

Choose a location for the switch. Route the lighted flag wires to this area and cut them. Install the output end of the switch to the wires from the lighted flag using the provided butt splice connectors and heat shrink. Attach the remaining length of wire that you cut from the lighted flag to the input end of the switch using the provided butt splice connectors and heat shrink. Crimp the included large ring terminals onto the wires coming from the switch and attach them to the battery.

-To control the Lighted Flag with key on power and the provided switch.

Use a test light to locate key on power and tap into the wires using the provided posi tap connectors. Choose a location for the switch. Route the lighted flag wires to this area and cut them. Install the output end of the switch to the wires from the lighted flag using the provided butt splice connectors and heat shrink. Attach the remaining length of wire that you cut from the lighted flag to the input end of the switch using the provided butt splice connectors and heat shrink. Strip 1/4" of the insulation off the end of the wire and install them into the wire tap connectors.

#### WARNING:

This indication alerts you to the fact that ignoring the contents described herein can result in potential serious injury or death if not followed.

#### CAUTION:

This indication alerts you to the fact that ignoring the contents described herein can or will result in material damage and/or personal injury.

#### ATTENTION:

This indication alerts you to the fact if you ignore this detail you will affect the performance or functionality of the product.

All Ciro products are designed for "easy assembly" and/or "plug and play". We recommend a competent mechanic install our products, using standard mechanical procedures to assure a safe and successful installation.

#### NOTE:

Ciro® warrants that products sold hereunder to the original purchaser, if maintained and operated under normal conditions, shall be free from any defects in materials and workmanship for a period of (3) years from date of purchase, and a lifetime warranty against LED failure.

Ciro will have no obligation if the customer cannot show proof of purchase.

Warranty will not be granted unless the part is properly installed and maintained.

Ciro will not be liable for any consequential and incidental damages, including labor, or non-Ciro products.

Please visit our website [Ciro3d.com](http://Ciro3d.com) for our complete warranty policy.

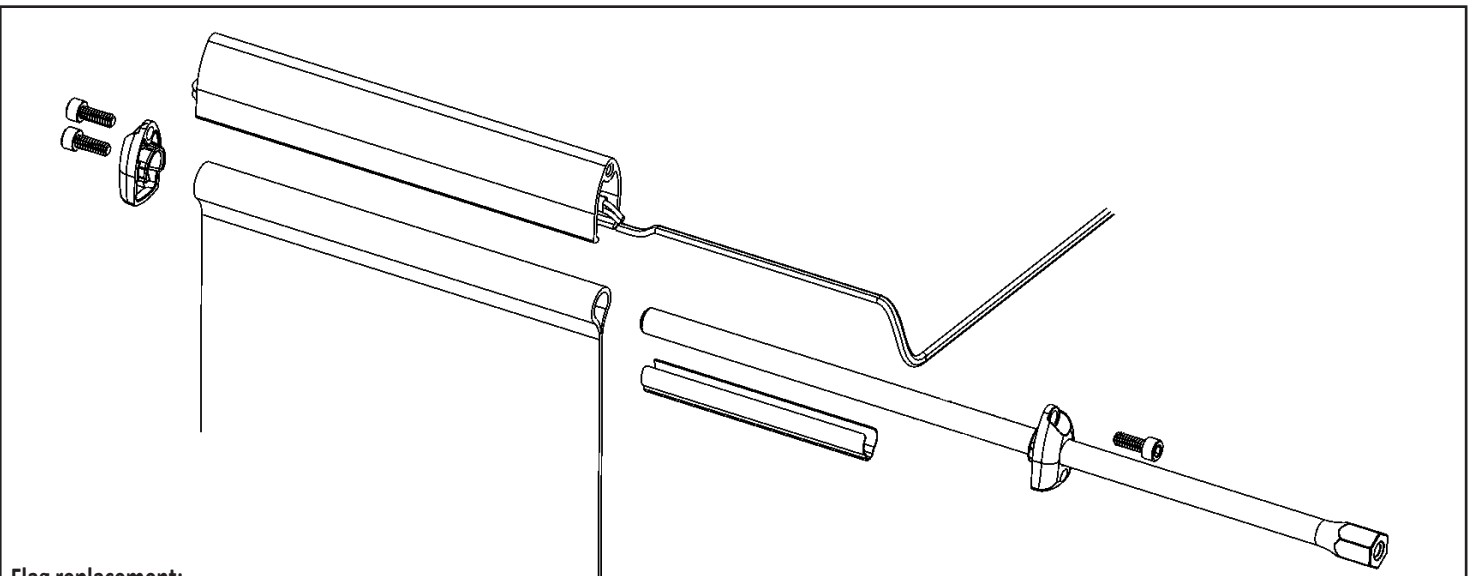
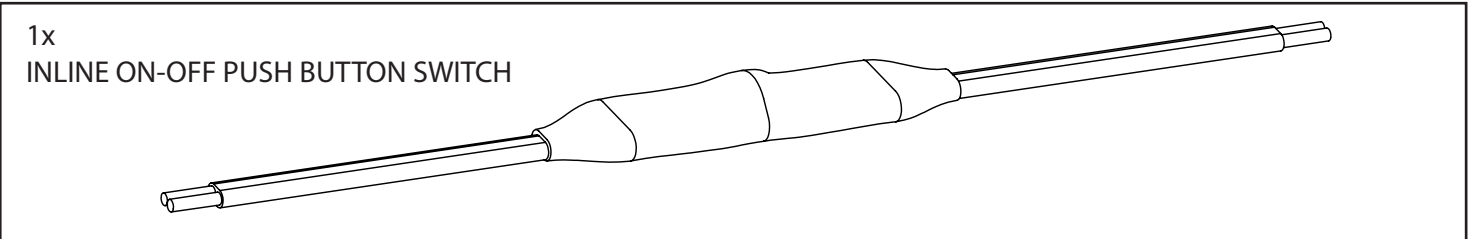
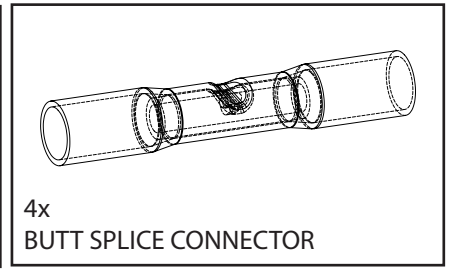
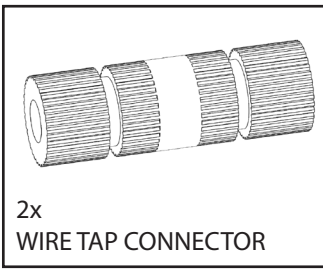
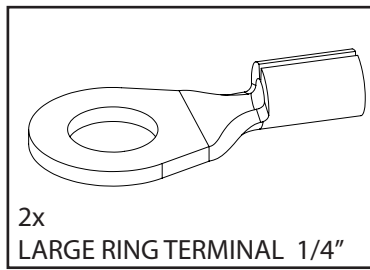
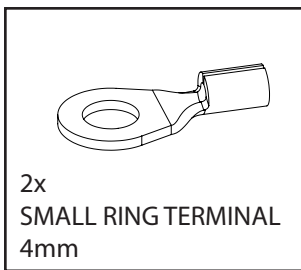
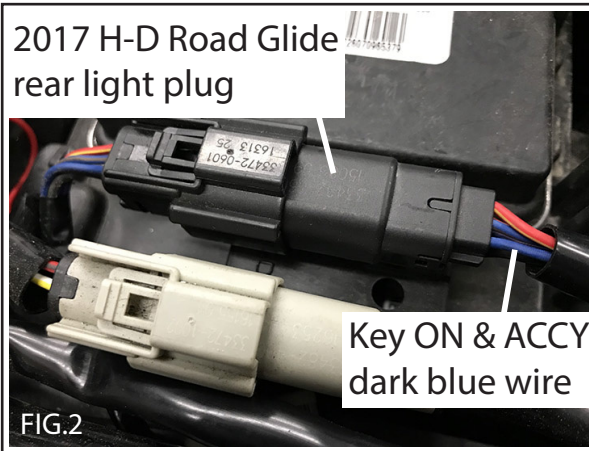
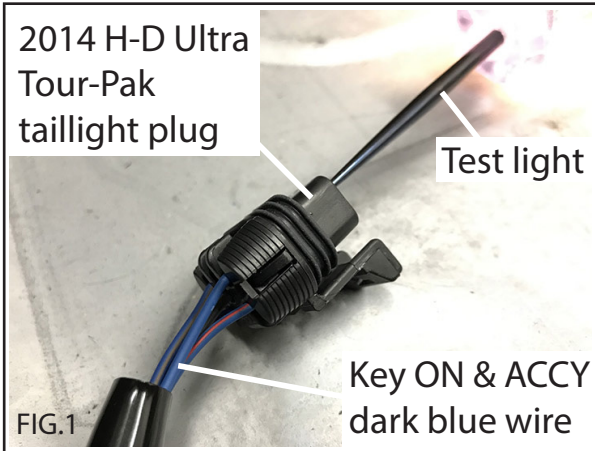

**Flag replacement:**

1. Remove the wire retainer then the top and bottom caps using the provided hex key.
2. Hold onto the light housing and carefully slide the flag mast out the bottom of the assembly. Remove the flag.
3. When re-installing the flag make sure to route the wire carefully.
4. Place the flag into the light housing and slide the mast up into the assembly.
5. Attach the bottom cap first followed by the top cap. Reinstall the wire retainer.