



# INSTALLATION INSTRUCTIONS

## Winch Mount Kit

Part Number: 101394

Application: 2018 Can Am Maverick X3

### GENERAL SAFETY PRECAUTIONS

Your safety, and the safety of others, is very important. To help you make informed decisions about safety, we have provided installation and operating instructions and other information on labels and in this guide. This information alerts you to potential hazards that could hurt you or others. It is not possible to warn you about all potential hazards associated with this product, you must use your own good judgment.

**CARELESS INSTALLATION AND OPERATION CAN RESULT IN SERIOUS INJURY OR EQUIPMENT DAMAGE. READ AND UNDERSTAND ALL SAFETY PRECAUTIONS AND OPERATING INSTRUCTIONS BEFORE INSTALLING AND OPERATING THIS PRODUCT.**

This guide identifies potential hazards and has important safety messages that help you and others avoid personal injury or death. WARNING and CAUTION are signal words that identify the level of hazard. These signal words mean:

▲WARNING signals a hazard that could cause serious injury or death, if you do not follow recommendations. ▲CAUTION signals a hazard that may cause minor to moderate injury, if you do not follow recommendations.

This guide uses NOTICE to call attention to important mechanical information, and Note: to emphasize general information worthy of special attention.

### ▲ WARNING

#### IMPACT AND MOVING PARTS ENTANGLEMENT HAZARD

Failure to observe these instructions could lead to severe injury or death

- **Always** take time to fully read the Instructions and/or Operations Guide, and/or Basic Guide to Winching Techniques, in order to understand your winch and its operations.
- **Always** use extreme caution when drilling on any vehicle. Make sure that all fuel lines, brake lines, electrical wires, and other objects are not punctured or damaged when/if drilling on the vehicle. Thoroughly inspect the area to be drilled (on both sides of material) prior to drilling, and relocate any objects that may be damaged. Failure to inspect the area to be drilled may result in vehicle damage, electrical shock, fire or personal injury.
- **Always** wear safety glasses when installing this kit. A drilling operation will cause flying metal chips. Flying chips can cause eye injury.
- **Always** use extreme caution when cutting and trimming during fitting.
- **Always** remove jewelry and wear eye protection.
- **Never** lean over battery while making connections.
- **Never** route electrical cables:
  - o Across any sharp edges.
  - o Through or near moving parts.
  - o Near parts that become hot.
- **Always** insulate and protect all exposed wiring and electrical terminals.
- **Always** install terminal boots as directed in installation instructions.
- **Always** use appropriate and adequate care in lifting components into place.
- **Always** insure components will remain secure during installation and operation.
- **Always** tighten all nuts and bolts securely, per the installation instructions.
- **Always** perform regular inspections and maintenance on the plow mechanism, fasteners, cable and related hardware.
- **Always** replace all worn or damaged parts before operating.
- **Never** operate this WARN product with damaged or missing parts.

Read installation and operating instructions thoroughly.

WARN INDUSTRIES, INC. 12900 S.E. Capps Road,  
Clackamas, OR USA 97015-8903, 1-503-722-1200, FAX: 1-503-722-3000  
Customer Service: 1-800-543-9276  
Dealer Locator Service: 1-800-910-1122  
International Fax: 1-503-722-3005

## CAUTION

### MOVING PARTS ENTANGLEMENT HAZARD

Failure to observe these instructions could lead to minor or moderate injury

- **Always** take time to fully read and understand the installation and Operations Guide included with this product.
- **Never** operate this product if you are under 16 years of age.
- **Never** operate this product when under the influence of drugs, alcohol or medications.

Read installation and operating instructions thoroughly.

## NOTICE

### EQUIPMENT DAMAGE

- **Never** tow vehicle by attaching a tow bar to the eyelets on the bumper.
- **Never** attach tow bars directly to the bumper. Damage to bumper may occur. WARN bumpers are not designed to be used for flat towing. Consult with the manufacturer of your tow bar system for the proper vehicle tow bar brackets..

Read installation and operating instructions thoroughly.

## TABLE OF CONTENTS

Tools Required.....	page 2
Torque Specifications.....	page 2
Parts List.....	page 3
Installation.....	page 4-7
Maintenance/Care.....	page 7

## TOOLS REQUIRED

- Standard wrenches
- Standard sockets

## TORQUE SPECIFICATIONS

Please use the recommended torque specifications when assembling this product unless otherwise specified in the instructions.

FASTENER SIZE			FASTENER TORQUE		
	lb-ft	(N.m)		lb-ft	(N.m)
1/4"	8	(11)	M4	(2)	3
5/16"	17	(23)	M5	(4.5)	6
3/8"	30	(40)	M6	(7.5)	10
7/16"	48	(66)	M8	(18)	25
1/2"	74	(100)	M10	(37)	50
9/16"	106	(144)			
5/8"	148	(200)			
3/4"	269	(364)			

# PARTS LIST

ID No.	Item No.	Description	Qty.	ID No.	Item No.	Description	Qty.
A1	101398	FAIRLEAD ASSEMBLY	1	B1	83349	M6 FLAT WASHER	2
A2	101395	WINCH MOUNT ASSEMBLY	1	B2	60595	M6 LOCKING NUT	2
				B3	22491	M8 LOCKING NUT	4
				B4	1324	5/16 FLAT WASHER	8
				B5	22508	M8 HEX BOLT	4

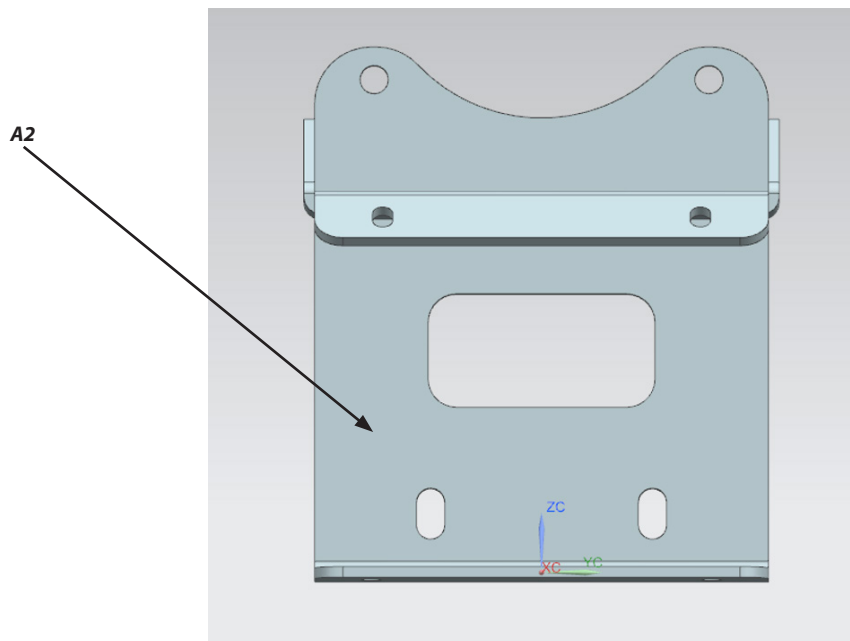
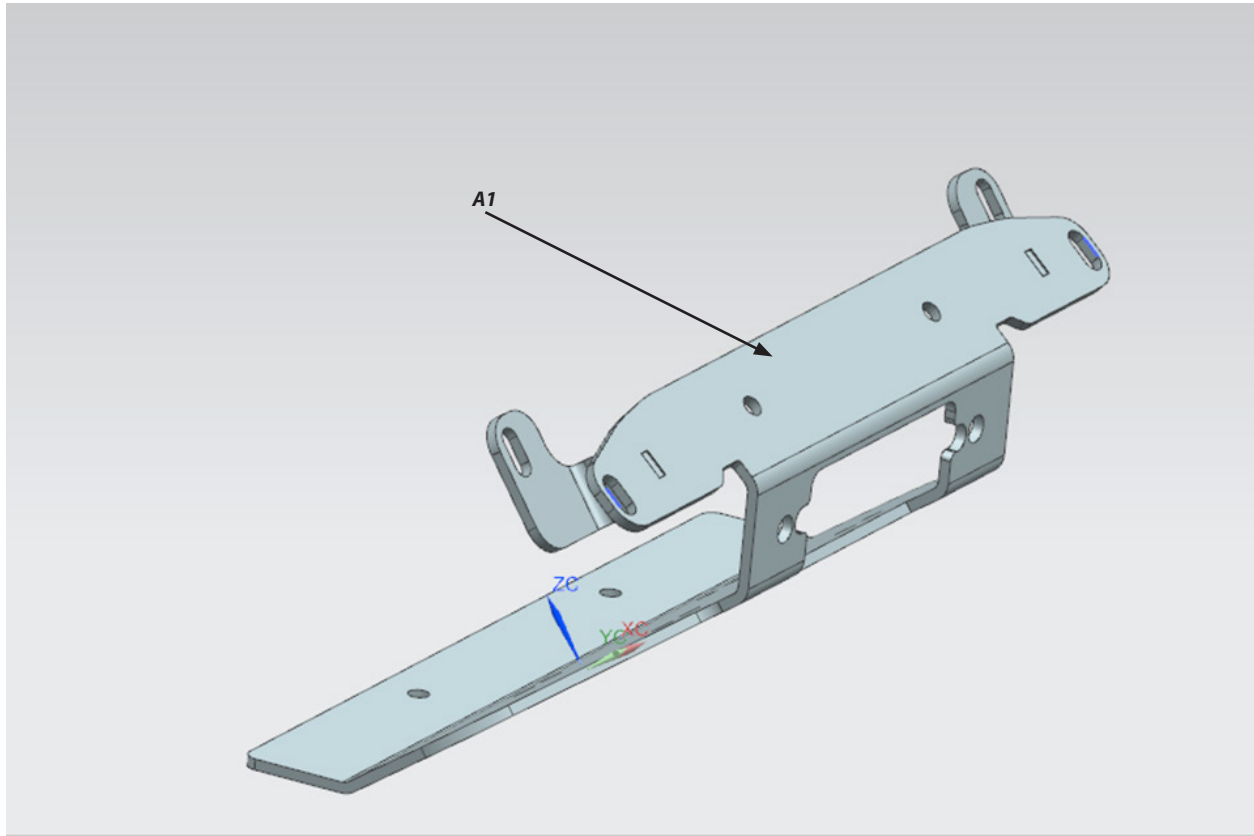

## INSTALLATION INSTRUCTIONS

1. Remove the screws that hold the front plastic to the bumper structure.



Figure 1

2. Remove the fastener to the bottom of the radiator bracket on both sides.

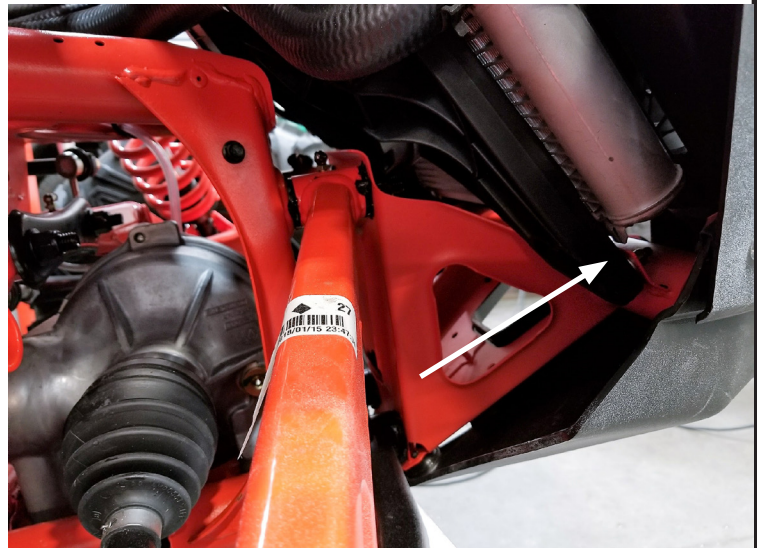

Figure 2

3. Remove the nuts holding the lower A-Arms..



Figure 3



## INSTALLATION INSTRUCTIONS

4. Remove the upper A-Arm nuts from both sides.
5. Lift up on the front of the plastic and pull the bumper structure outward off the studs that hold the A-Arms. *Use care in not damaging radiator while removal.*

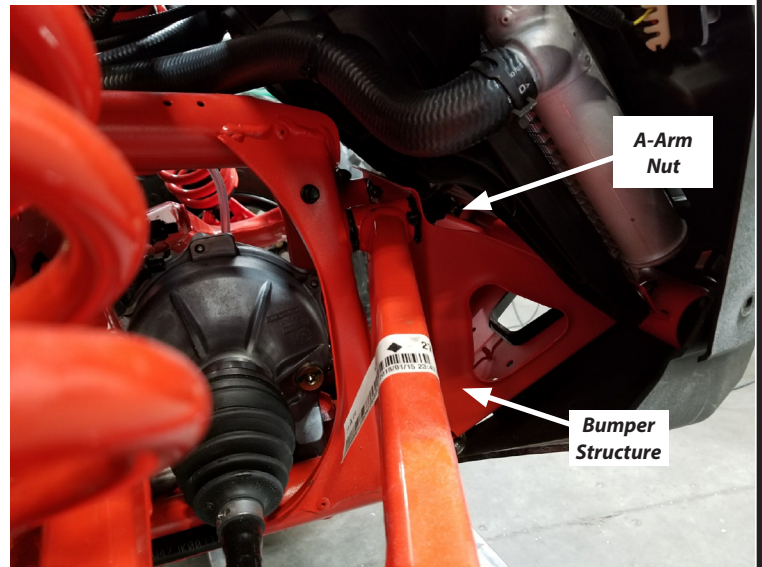

Figure 4

6. The front of the Maverick is now ready to install the rear weldment of the winch mount.



Figure 5

7. Place the rear winch mount weldment over the four A-Arm mounting bolts shown in previous picture. Use the same orientation as shown in picture.

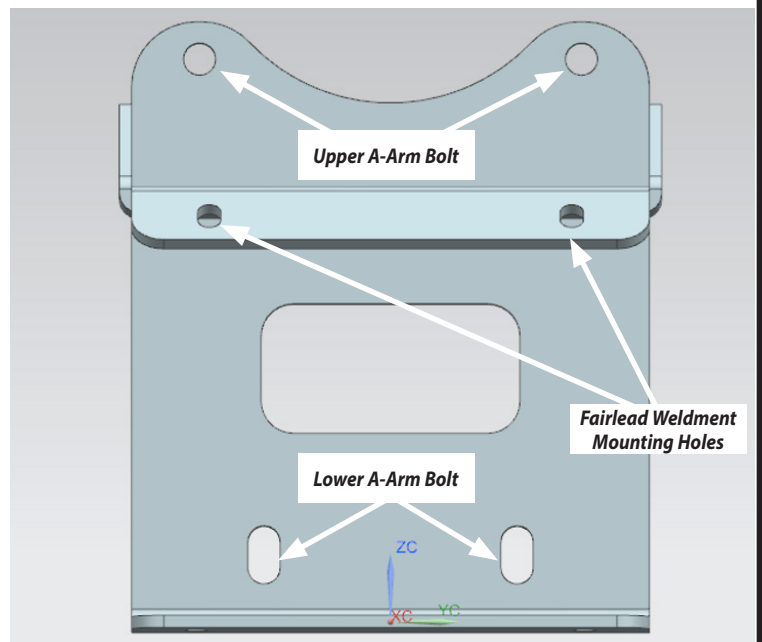

Figure 6

8. Attach the fairlead weldment using hardware supplied to the rear weldment you just installed.

The image indicates the mounting locations for radiator, fairlead mount, vehicle plastic and winch mount. and the location to reattach the radiator and the vehicles plastic.

**NOTE:** It may be easier to attach the fairlead to the weldment before installing (hardware supplied in your winch kit).

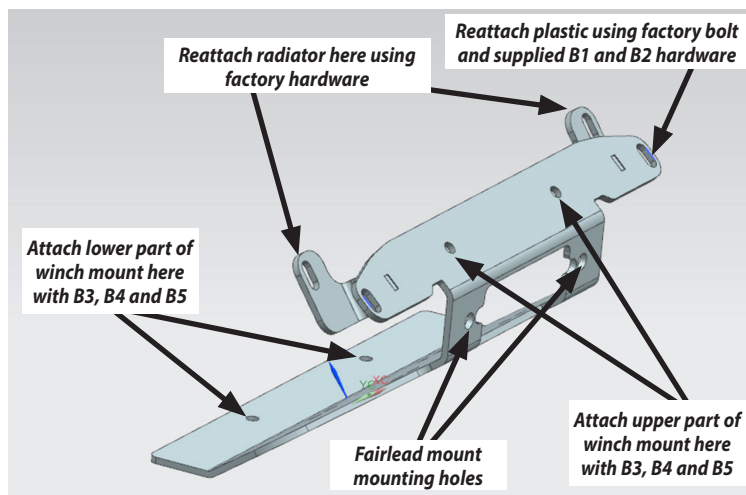

Figure 7

9. Before you install winch, review Figure 8. The illustration shows correct winch orientation. Notice the winch clutch handle should be on the passenger side of the vehicle. The winch rope winds off the top of the winch drum and through the fairlead opening.

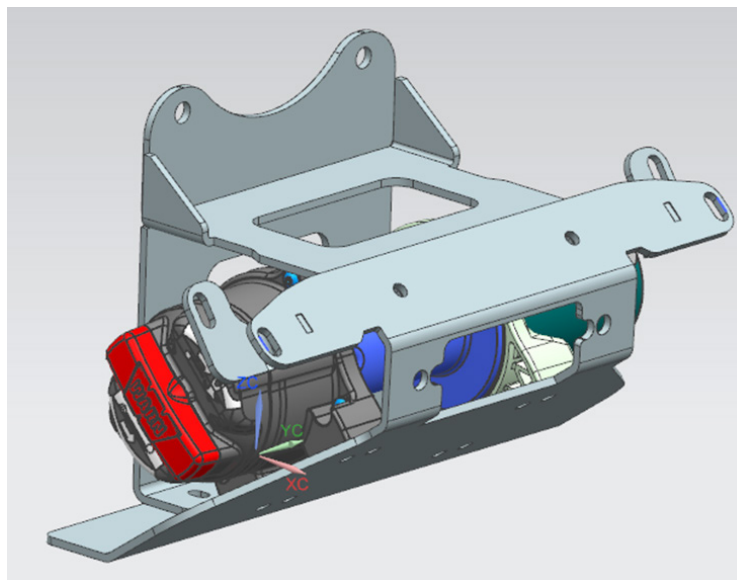

Figure 8

10. Slide winch into position. Install using hardware and instructions found in your winch kit.



Figure 9

11. Installation is complete.



*Figure 10*

## **MAINTENANCE / CARE**

1. Inspect all parts on the winch, winch mount, and related hardware prior to each use. Replace all hardware that appears rusted or deformed.
2. Inspect all nuts and bolts on the winch, winch mount and related hardware prior to each use. Tighten all nuts that appear to be loose. Stripped, fractured, or bent bolts or nuts need to be replaced.
3. Check all cables prior to use. Replace cables that look worn or frayed.
4. Check all moving or rotating parts. Remove debris that may inhibit the part from moving freely.