



INSTALLATION INSTRUCTIONS

CFMOTO ZFORCE 950 SPORT

VENT REAR WINDSHIELD

PART # 78-3500V-R

IMPORTANT NOTICES

READ AND UNDERSTAND THESE INSTRUCTIONS COMPLETELY BEFORE INSTALLATION TO AVOID INJURY TO YOURSELF, DAMAGE TO THE VEHICLE OR ACCESSORY.

- For proper installation, TWO people are required.
- Torque specifications must be followed when tightening bolts. Over-tightening any and/or all screws will cause cracks around mounting holes which is not covered by any warranty.
- As specified on carton label, once protective film on shields is removed, product cannot be returned.
- As specified on carton label, damage caused by packaging staples is not covered by warranty. All staples must be removed prior to removing product from carton.
- ANY cutting, trimming, drilling or altering of this product as delivered is not covered under warranty.
- Failure to follow these installation instructions completely may void any warrantable components and result in product damage or personal injury.
- Do not use Loctite/Super Glue or any other similar fastener adhesive. These types of products react to plastics and cause cracking. Not covered by any warranty.
- Our windshields are made from the highest quality material providing optimum transparency and clarity. Blurriness and/or extrusion marks may or may not appear when looking through windshield from a wide, side-angle. This is normal for all extruded clear plastic materials.
- The application of improper cleaners, abrasive and/or dirty cleaning towels can severely damage the product. Failure to follow cleaning recommendation (provided herewith) may void any warrantable components.

DEALER

These instructions contain important information for future reference and must be given to the customer at time of purchase or upon completion of installation.

Parts List (parts available with kit only and not available separately)

ITEM	PART NAME	DESCRIPTION	QTY
A	Rear windshield	CNC rear windshield cut-out made of 1/8" thick GE polycarbonate or equivalent	1
B	Lower center panel	CNC lower center panel cut-out made of 1/8" thick GE polycarbonate or equivalent	1
C	Vent assembly	Includes: 1 vent cover, 1 vent flap assembly, 1 rubber vent seal and 7 vent mounting screws	1
D	Co-extruded bulb seal (1/4")	Includes: 45" Co-extruded bulb seal (1/4") / #77-95BS [end user to cut to exact length]	1
INSTRUCTION BAG	E	Flop clamp set	1
	F	Nuts & bolts	1

1. Installation

- a) Insert the injected rubber pad spacers (Item E) to all clamps as shown below.

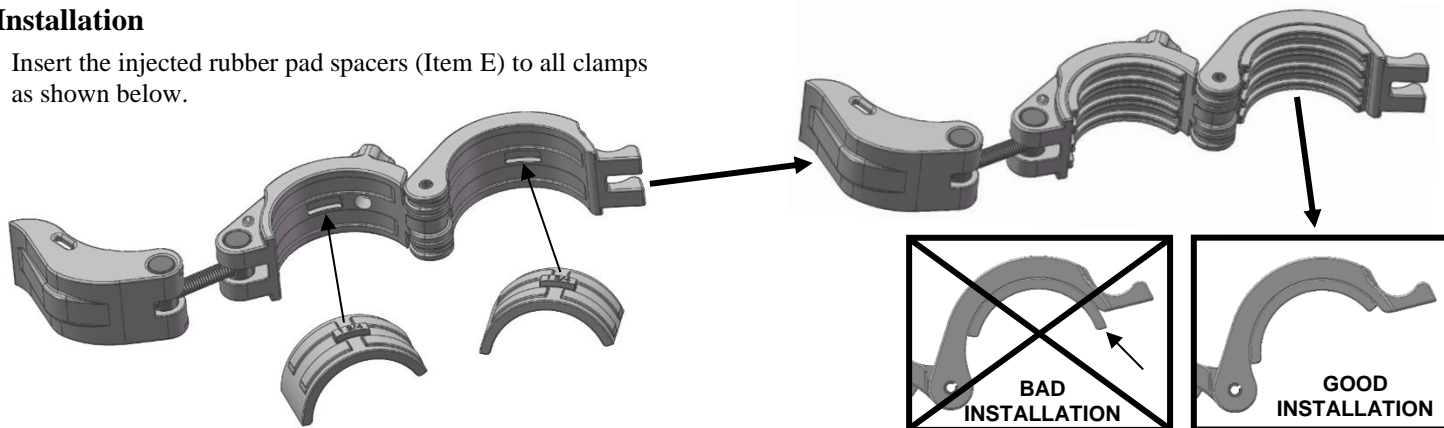

IMPORTANT NOTICES

Over-tightening any and/or all screws will cause cracks around mounting holes which is not covered by any warranty.

- b) Attach the clamps to the roll-cage as shown below and pre-adjust tightening tension of all clamps. **NOTE: Keep all clamp handles open as shown in step 3 below; this will allow you to move the clamps up or down when installing the windshield for the first time.**

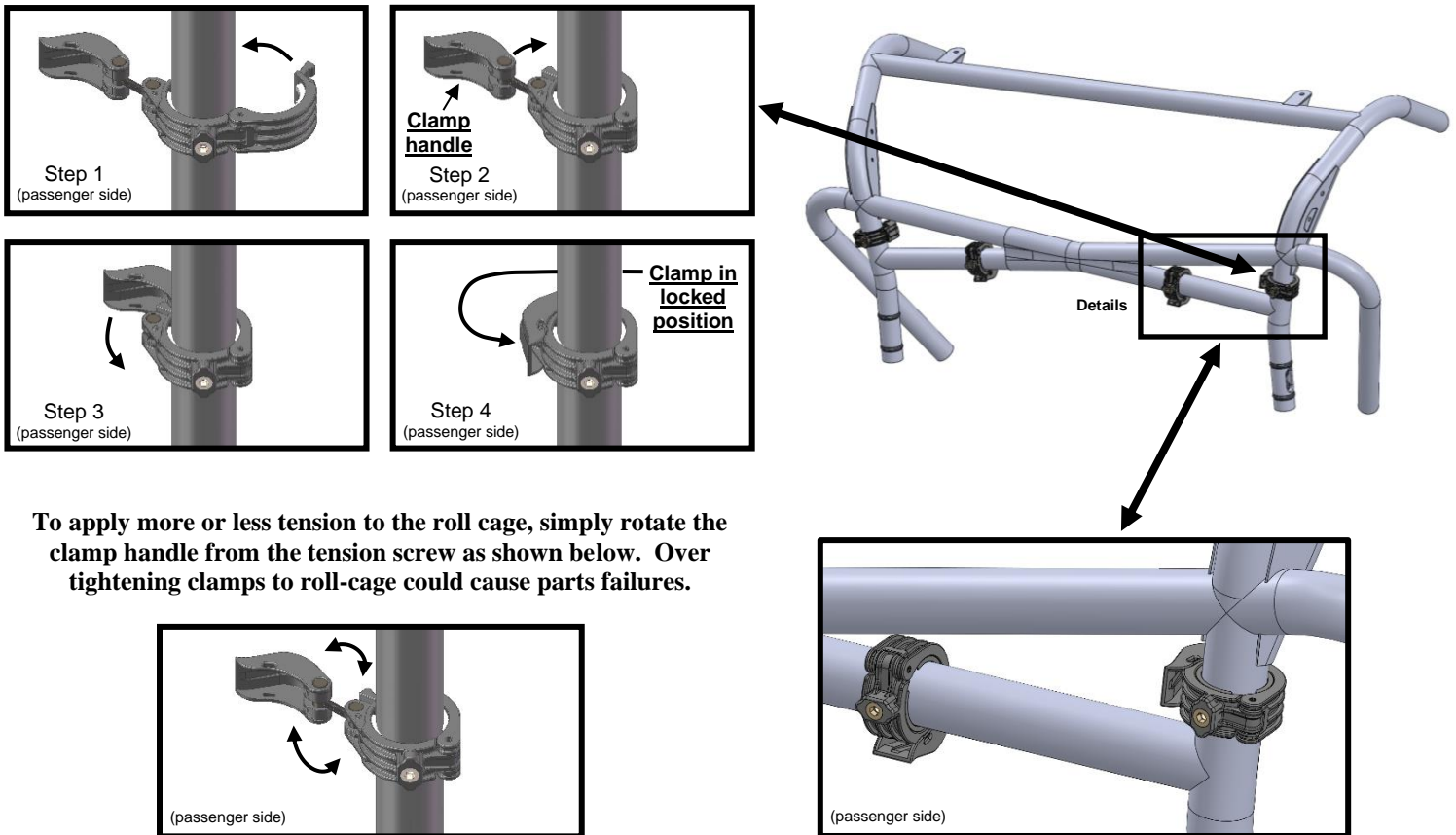

- c) Partially remove the protective film on both sides and assemble the lower center panel part (Item B) to the rear windshield (Item A) using supplied push type retainers ($\frac{5}{16}$ ") (Item F) as shown below.

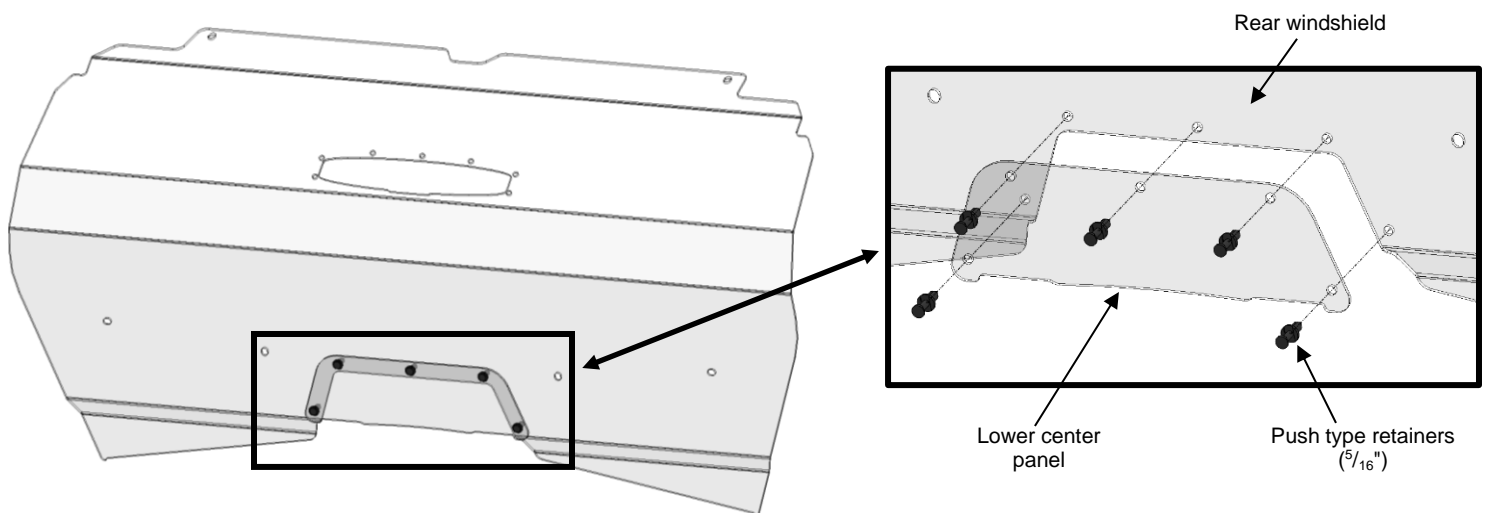

IMPORTANT NOTICES

Torque specifications must be followed when tightening bolts.

Over-tightening any and/or all screws will cause cracks around mounting holes which is not covered by any warranty.

- d) Partially remove the protective film on both sides and apply the co-extruded bulb seal (Item D) to the lower lips using manual pressure to ensure good adhesion to the windshield and cut any excess. **(As shown, it must be applied in 3 pieces to allow removal of the lower center panel for vehicle maintenance.)**

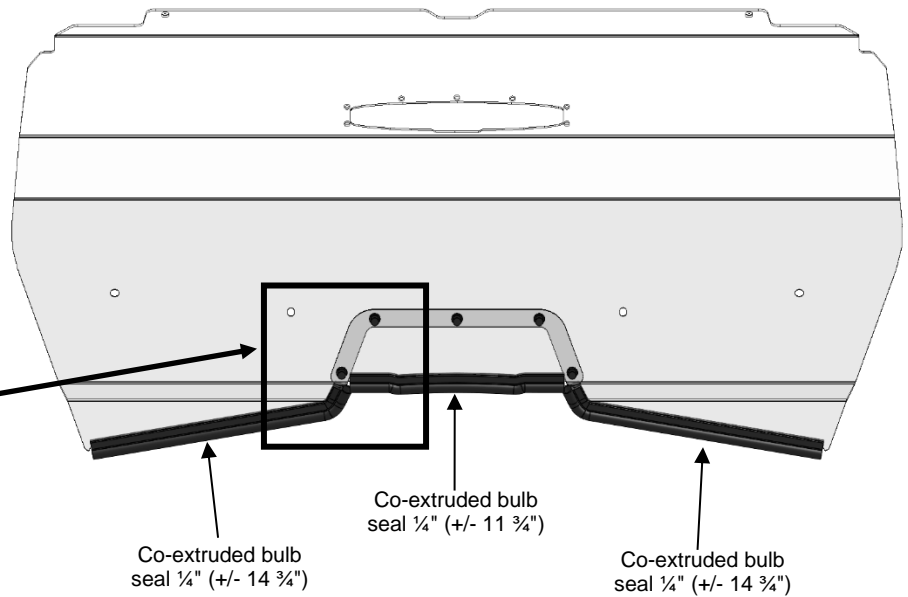
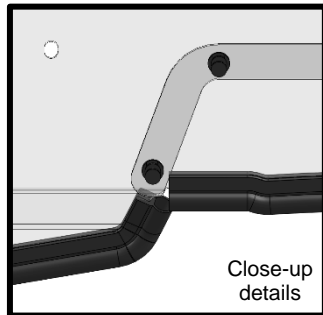

- e) **Vent assembly (Item C) installation:** Partially remove the protective film on both sides of the windshield around the vent cutouts and follow instructions below.

- a. From the front side (cab side) of the windshield, slide the vent flap assembly in the vent cut out as shown in image e1. Ensure the lower tab nests into the front of the windshield as shown in image e2 & e3.

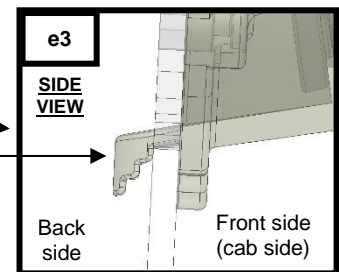
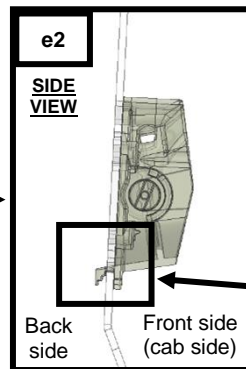
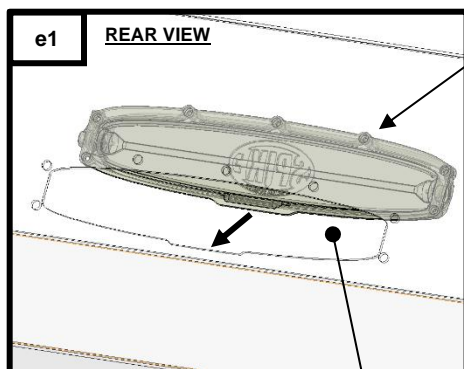
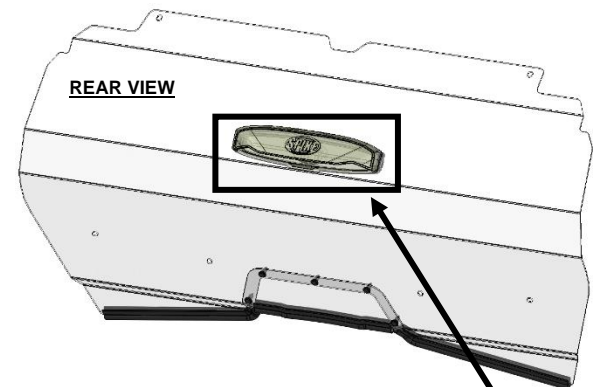

MORE DETAILS ON NEXT PAGE

IMPORTANT NOTICES

Torque specifications must be followed when tightening bolts.

Over-tightening any and/or all screws will cause cracks around mounting holes which is not covered by any warranty.

- b. Install the remaining vent components (Item C) using supplied hardware as shown below in image e4 & e5.

Caution: over tightening any hardware could cause irreversible damage to the windshield.
DO NOT USE POWER TOOLS FOR THE INSTALLATION OF THE 7 MOUNTING SCREWS.

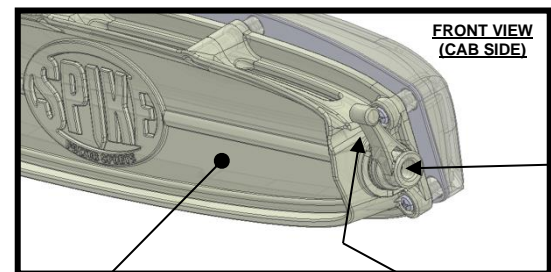
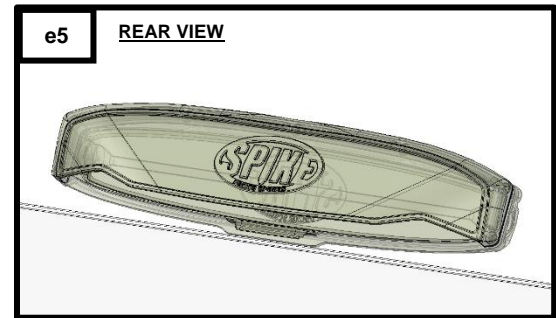
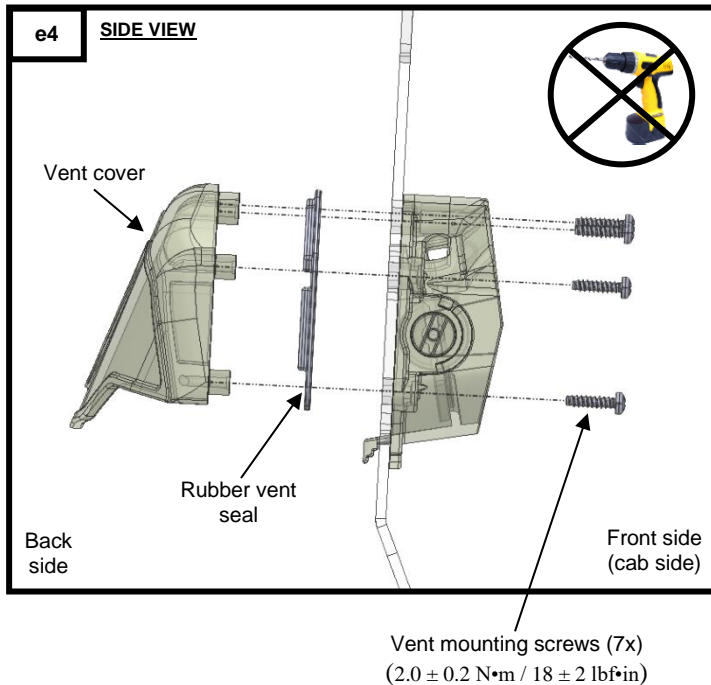

As shown on the rear-view image, the **lever** is installed by default on the right side of the vent. Lever can be installed/relocated on left or right side of the vent. End user can decide.

Tightening/Loosening of the **screw** in the lever determines the force required for the **baffle** adjustment.

- f) Install the windshield to all clamps and cage as shown below using supplied hardware (Item F) without applying final torque. Adjust the position of the windshield and tighten all screws **with specified torque indicated below**. **Over-tightening clamps to roll bar could cause parts failures.**

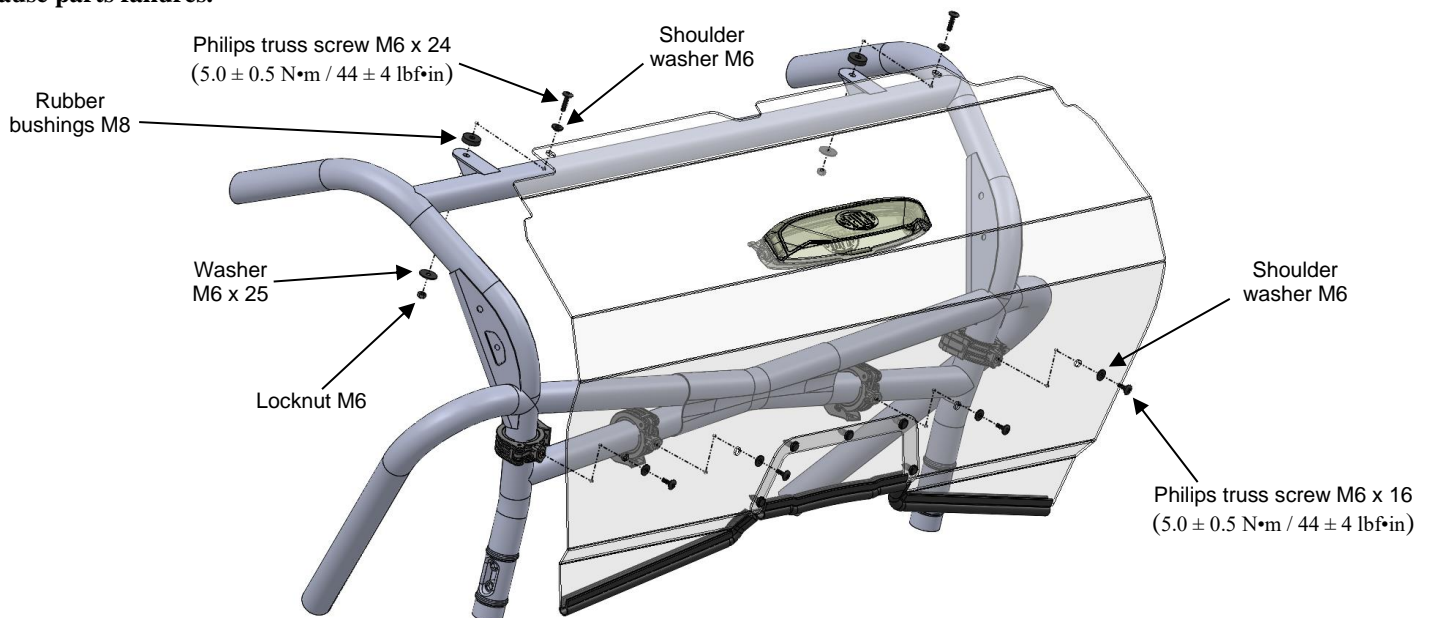

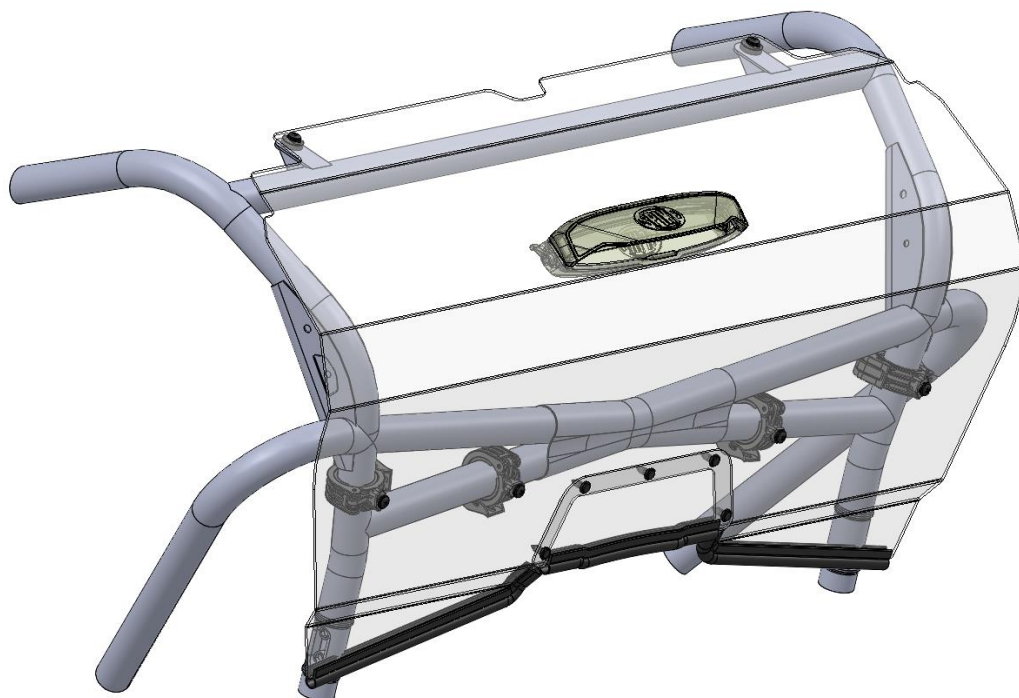

IMPORTANT NOTICES

Trailerable ONLY with a FULL Front windshield AND Roof - or damage can occur!
Due to extreme wind turbulence, towing on an open trailer pulled by a motor home, bus or other large size vehicle at highway speeds is NOT recommended.

CAUTION

Limited Towing at lower speeds (60mph or less) for shorter distances is acceptable with a FULL Front Windshield AND Roof ONLY. Prolonged towing at highway speeds on an Open trailer is NOT recommended and can cause damage that is NOT covered under Warranty. Whenever towing anytime, it is mandatory to check all windshield hardware BEFORE towing and at frequent intervals afterwards!
SPIKE suggests removal of Rear Windshields if towed in any conditions that are NOT recommended - removal will also create less drag on the tow vehicle

2. Maintenance and Care

Tighten all hardware after first use and periodically thereafter.

CLEANING:

- Rinse with lukewarm water; wash gently with mild soap or detergent and lukewarm water, using a soft cloth or sponge. **DO NOT SCRUB** or use brushes or squeegees.
 - Rinse again. Dry with soft cloth or moist cellulose sponge to prevent water spotting.
- To remove wet paint, glazing compound or grease, rub lightly with a good grade of VM&P naphtha or isopropyl alcohol, then wash and rinse. **DO NOT USE GASOLINE.**

NOTICE: Abusive cleaning procedures by hand washing or automated washing equipment will eventually result in visual hazing, loss of light transmission and coating delamination.

Compatible Cleaning Agents

- Aqueous Solution of Soaps and Detergents

Fantastik | Joy | Formula 409 | Mr. Clean | Top Job | VM&P grade Naphtha | Hexcel, F.O. 554 | Neleco-Placer