

CUSTOM CHROMETM

Instructions

Adjustable Floorboard Kit - FXST CCI #26-568, 26-569

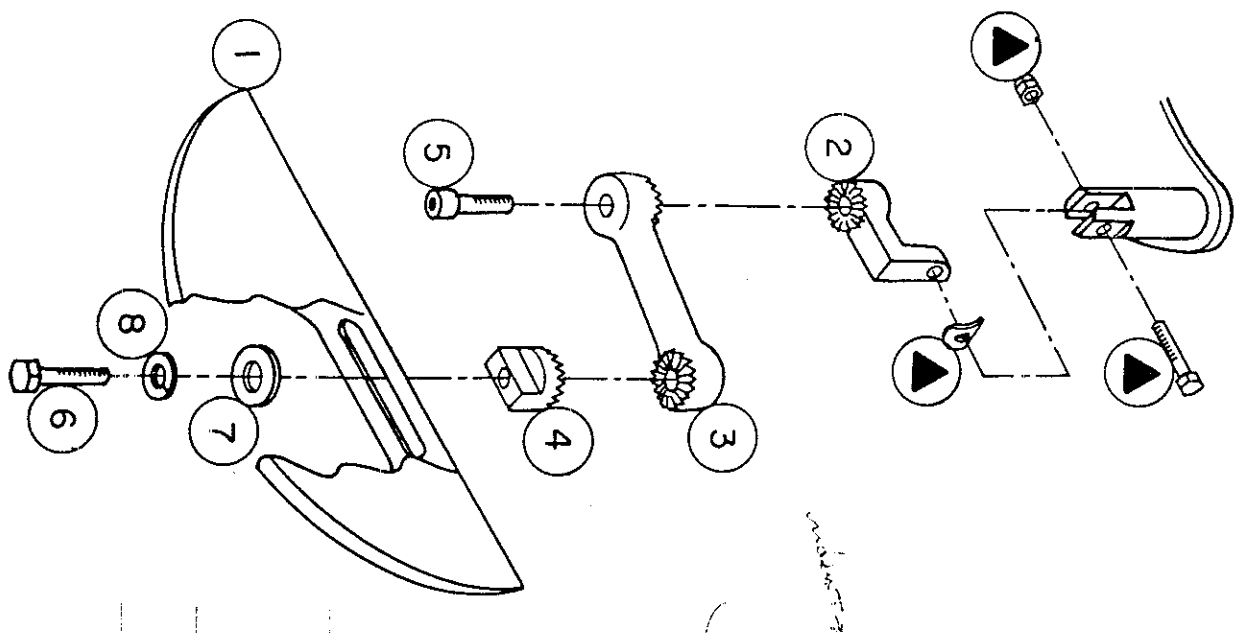

Brake Side

1. Remove original drivers footpeg.
2. Install pivot (2) in direction shown using original OEM footpeg hardware (A). Tighten hardware so there is a slight drag on pivot (2). Do not over tighten.
3. Install dogbone (3) with allen bolt (5) finger tight for now. Dogbone (3) may be installed pointing to the front or rear of motorcycle depending on desired floorboard position.
4. Install floorboard (1) as shown using hexbolt (6), lockwasher (8), flatwasher (7), and slot adjuster (4) finger tight for now.
5. Floorboard (1) can now be adjusted to final desired position by rotating dogbone (3) and slot adjuster (4) on their serrated teeth, and sliding floorboard back and forth on slot adjuster (4). **Caution:** Floorboard should be positioned in such a way that there is at least 9" of ground clearance. See *Illustration A*. This proper ground clearance of 9" allows for safe operation of vehicle in all turning and cornering situations.
6. All mounting hardware ((5), (6), (7), (8)) can now be tightened to proper torque specs (30-35 ft.lbs.) Make sure thread lock has been used on all hardware.

Shifter Side

1. Remove original drivers footpeg.
2. Repeat steps 2 thru 6 as listed on brake side instructions. Make sure shift side floorboard is in same final position as brake side floorboard.

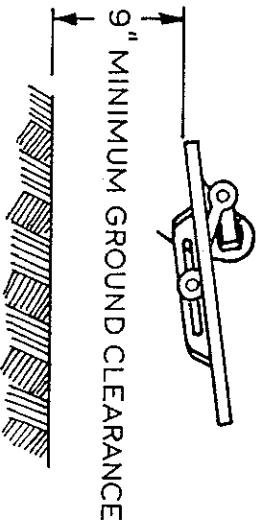

Illustration A