



Thank you for purchasing our product. Before installing/operating the product, read the instructions carefully and retain them for future reference.

## ⚠ Attention!

- For installation, follow the steps described. Any damage caused by wrong installation shall be imputed to the users.
- Do not disassemble or change any parts. Opening and disassembling this unit will void any warranty.
- Maintenance and repairs should be executed by our professionals only.

### NOTE

⚠ Some procedures must be followed to avoid damages to the product.

⚠ **WARNING!** Certain procedure must be followed to avoid damages to yourself, to the vehicle or to others.

## 1-1 ACCESSORY

### 1 CONNECTING TUBE



## 1-2 Optional Accessories

### 1 CYLINDER



### 2 THROTTLE BODY

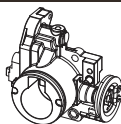

### 3 INTAKE MANIFOLD X1

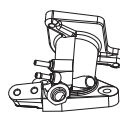

### 4 AIR FILTER COVER

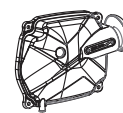

### 5 AIR FILTER



## 2 INSTALLATION INSTRUCTIONS

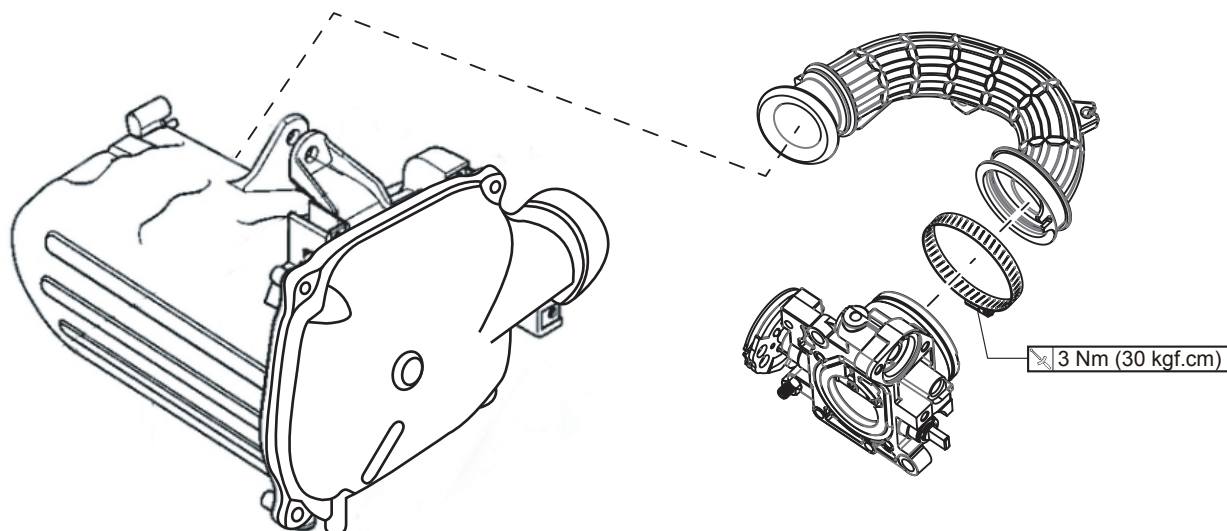

### Proceed as follows

1. Use appropriate tools to remove the original air filter connecting pipe and throttle valve.
2. Clean up the connecting hole of the air filter shell.
3. Install the KOSO air filter to the air filter body.
4. Apply silicone around the area to keep it airtight and fixed, and the installation can be completed.

### 3 DYNO TEST CHART

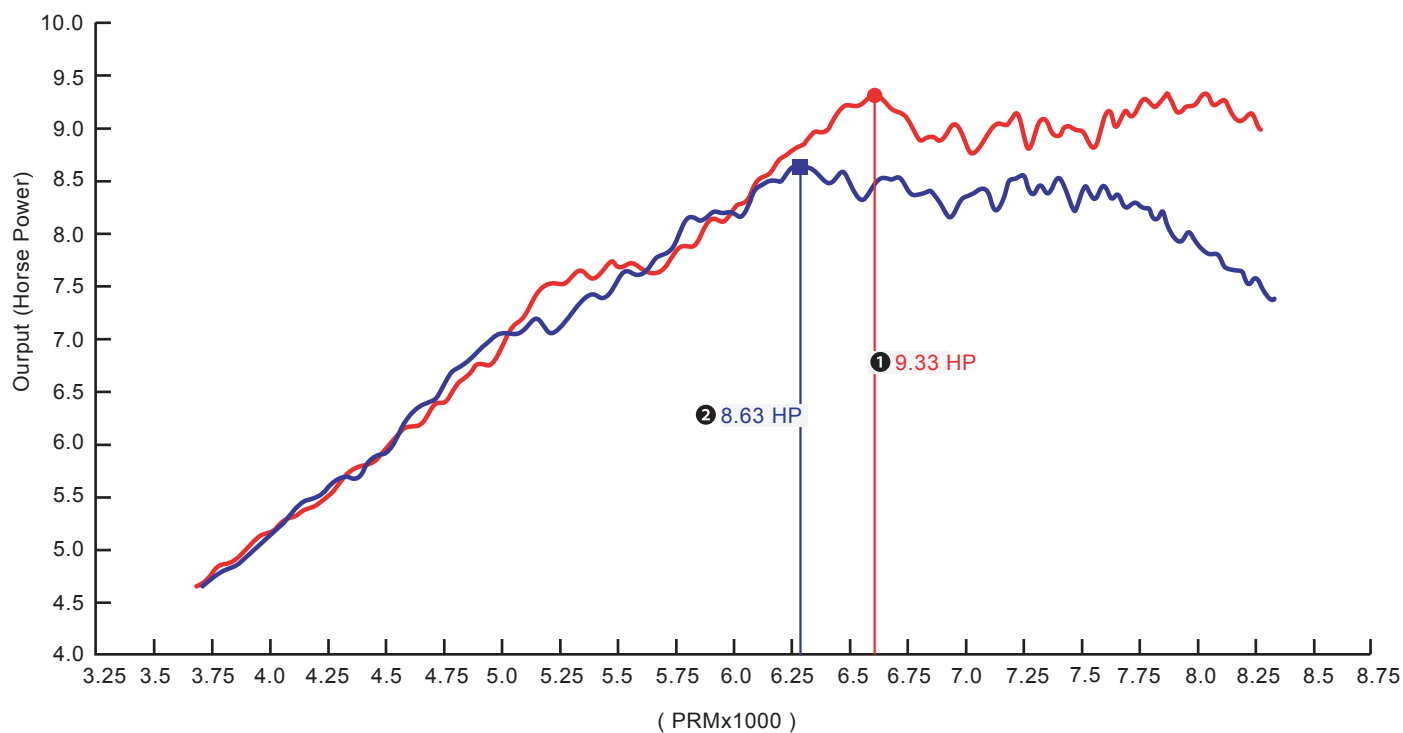
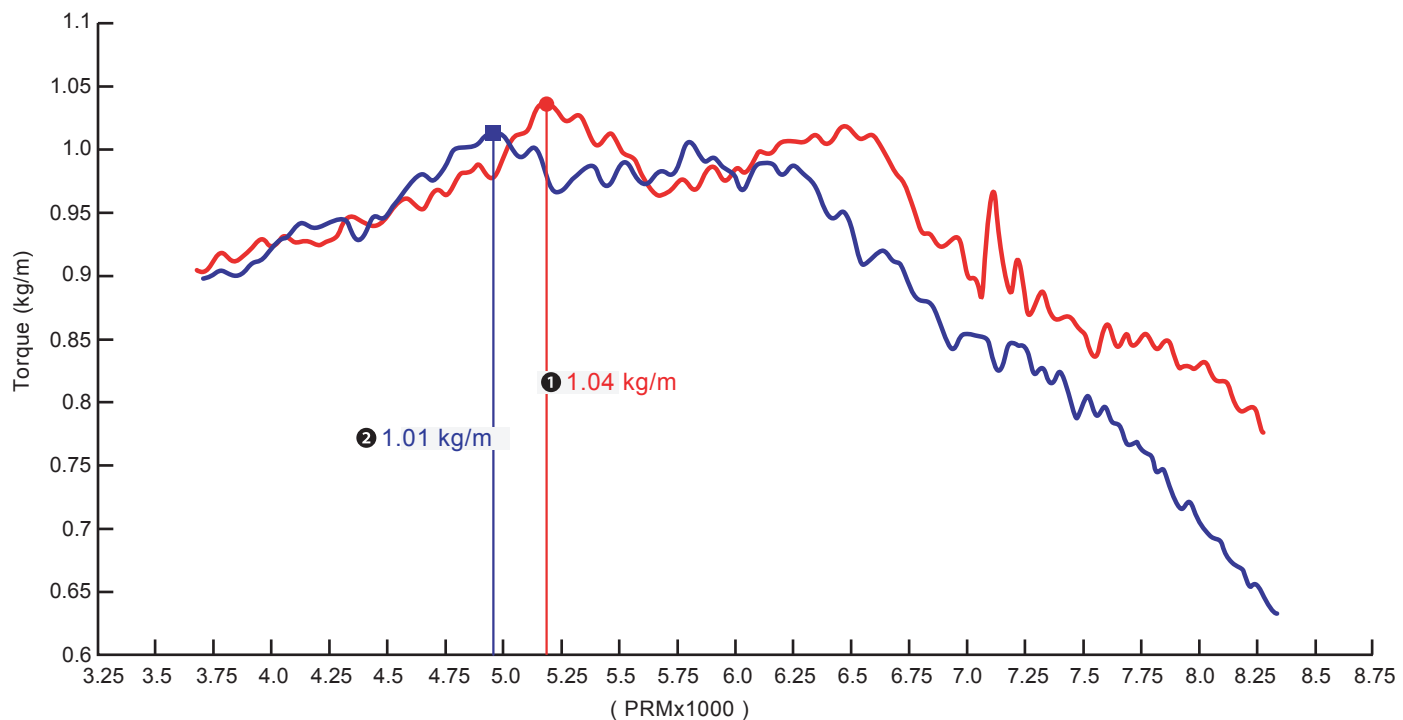

**NOTE 1** KOSO Intake+KOSO Throttle body+KOSO Air cleaner box connection tube+KOSO Air filter cover

**NOTE 2** STD

**NOTE** Test results vary with testing environment and weather. This test chart is for reference only.