

KRAUS WORKMAN KICKBACK RISERS:

UN-RI-10 | UN-RI-15 | UN-RI-17 | UN-RI-19

- Riser can be installed onto tree and torqued according to spec
- Kraus workman risers will retain OEM bushings in top tree
- Bars can be installed directly into riser, once clocking of bars is determined, (6) 5/16-18 bolts can be installed and torqued to spec

OPEN ROAD KITS:

NOTE: Bushings will be supplied in Open Road Kits OEM rubber bushings can be removed from top tree and discarded. Replacement hard bushings will have to take their place

- Riser can be installed onto tree and torqued according to spec
- Bars can be installed directly into riser, once clocking of bars is determined, (6) 5/16-18 bolts can be installed and torqued to spec

TORQUE SPECS x6

5/16-18 | 10ft-lbs

*Blue Loctite is recommended

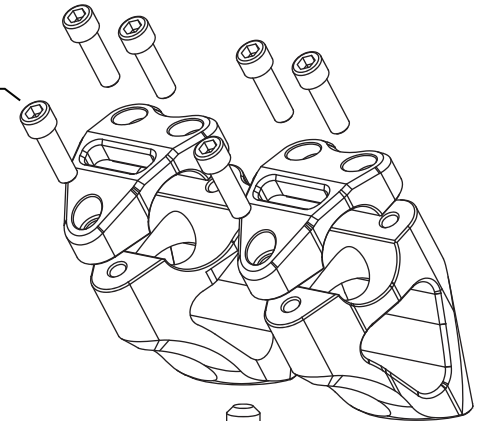

WORKMAN

FACTORY BUSHINGS FROM TOP TRIPLE TREE MAY BE USED

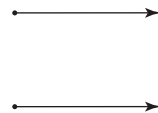
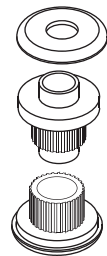

OPEN ROAD

OEM BUSHINGS CAN BE DISCARDED & REPLACED WITH INCLUDED SOLID BUSHINGS



TORQUE SPECS x2

1/2-13 | 55 ft-lbs

*Blue Loctite is recommended

