

INSTRUCTIONS



FLARE® WINDSHIELD FOR ROAD WARRIOR FAIRING

INCLUDED COMPONENTS:

- Flare® Windshield
- Installation Instructions

TOOLS NEEDED:

- Shine Werks (recommendation)

QUESTIONS?

- EMAIL: info@getklocked.com
- CALL: (605) 996.3700

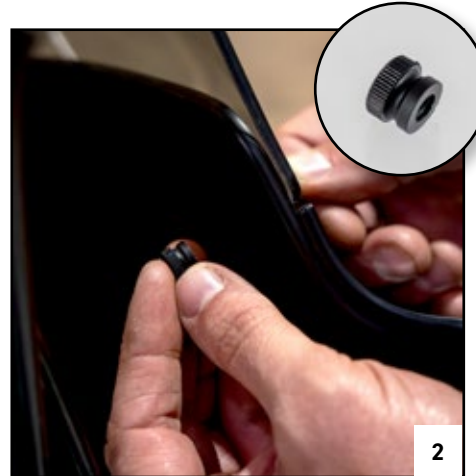

1. Loosen all six plastic screws and carefully remove your windshield from the fairing (FIG 1).
2. Ensure you hold onto the plastic nuts on the inside of the fairing (FIG 2).

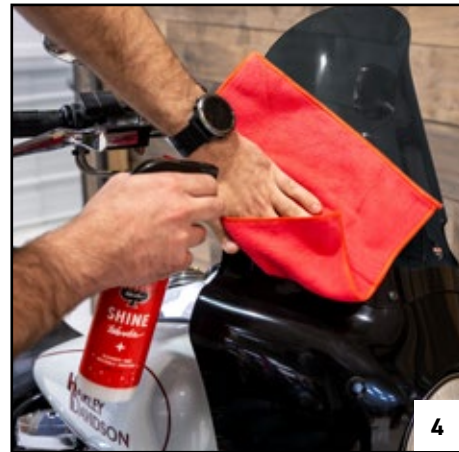
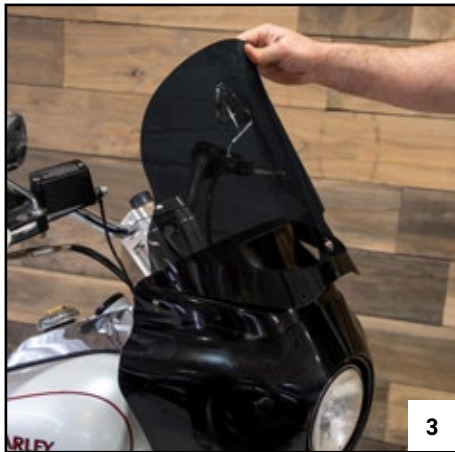

3. Install your new Flare® Windshield with the hardware removed in step 1 finger tight (FIG 3).
4. Using your Shine Werks, give the windshield and fairing a good wipe down and enjoy the ride (FIG 4).

WARNING! Using Loctite® or any type of thread locker on hardware will result in breakdown of the Polycarbonate and cause cracking.

Klock Werks cannot be held responsible for any damage resulting from improper installation performed by any consumer or their dealer.

U.S. Pat. No. D586,274; D632,235; D586,275; D633,017; D626,046; D633,018 Pat. 001050165-0001, 001050165-0002, 001050165-0003 APO No. 324093, 324094, 325192